

Poziție	Cant.	Descriere	Preț unitar
	1	<p>DMH 251 2.2-25</p>  <p>Notă! Poza de produs poate diferi de produsul actual</p> <p>Nr. Produs: 96721683</p> <p>The dosing pumps of the DMH series are hydraulic piston diaphragm pumps. They combine the leakage proof ness of the diaphragm pump with the output characteristics of a piston pump which is almost independent of pressure. DMH pumps are fitted whit the special Bitrac® drive assembly. It converts the rotational energy of the motor into a hydraulic energy by a constant piston system whit hydraulic phase angel control, and hydraulic diaphragm activation assembly with safety valve and patented active diaphragm protection system AMS. The flow rate can be accurately adjusted on a scale with a vernier linearly between 0 and 100%. The flow repeatability of the pumps is superb: below 1%</p> <p>The liquid end is composed of:</p> <ul style="list-style-type: none"> - Dosing head - Full Teflon diaphragm - Ball valves <p>Applies only to pumps with: ATEX certification</p> <p>The dosing pump DMH is certified according to the ATEX guideline RL 94/9/EC for non-electrical operating supplies.</p> <p>The motor versions EEx e and EEx d defined by Grundfos/Alldos are certified by the manufacturers according to ATEX guidelines for electrical operating supplies. The motor type plate is labelled according to ATEX.</p> <p>Other features:</p> <ul style="list-style-type: none"> - Robust industrial pump with aluminium enclosure - High rigidity of the hydraulic system and thus low pressure-dependence - High precision by hydraulic diaphragm activation and permanent degassing of the hydraulic system. - Pumps and plant safety by integrated hydraulic overpressure valve and diaphragm protection system. - Easy and precise adjustment of the flow rate 0-100%, also during the pump stop. - Universally resistance and extremely long life of the Diaphragm. <p>Electronics features:</p> <p>Applies only to pumps with control variant: AR</p> <p>Etron Profi microprocessor electronics, direct attached to motor:</p> <ul style="list-style-type: none"> - Stroke frequency adjustable from 1 stroke/min to maximum stroke frequency - Pulse control with multiplier and divisor - Analogue signal control 0/4-20 mA - Level control with input for two level signals. - Pulse, analogue and remote on/off input - Analogue output - Alarm relay output - Stroke output - Input for dosing controller and diaphragm monitoring sensor <p>Applies only to pumps with control variant: ATO</p> <ul style="list-style-type: none"> - Automatic adjustment of stroke length via direct drive control or mA-input signal - Block-proof synchronous motor with feedback potentiometer - Two limit switches 	La cerere

Poziție	Cant.	Descriere	Preț unitar
		<ul style="list-style-type: none"> - Positioning angle 270° - Fast adjustment: set-up time 0-100%:104 s at 50 Hz and 90 s at 60HZ. - For further specifications please refer to servomotor <p>Controls:</p> <p>Variante de control: AR</p> <p>Control nivel: Input for dual-level sensor or external start/stop</p> <p>Liquid:</p> <p>Lichide pompate: orice vâscozități fluid</p> <p>Temp. lichid: 20 °C</p> <p>Densitate: 998.2 kg/m3</p> <p>Technical:</p> <p>Aprobări pe etichetă: CE</p> <p>Materials:</p> <p>Corpul pompei (stator): Oțel inoxidabil, DIN 1.4401</p> <p>Supapă cu bilă: Oțel inoxidabil, DIN 1.4401</p> <p>Garnitură: FKM</p> <p>Instalație:</p> <p>Presiune de funcționare maximă: 25 bar</p> <p>Aspirație pompă: Threaded, Rp 1/4</p> <p>Refulare pompă: Threaded, Rp 1/4</p> <p>Electrical data:</p> <p>Puterea de intarare - P1: 0.09 W</p> <p>Frecvența rețelei electrice: 50 Hz</p> <p>Tensiune nominală: 1 x 120 V 50/60 Hz</p> <p>Grad de protecție (IEC 34-5): IP 65/F</p> <p>Protecție Ex standard: NO</p> <p>Lungimea cablului: 2 m</p> <p>Tip de conectare cablu: USA and Canada, 120 V</p>	

96721683 DMH 251 2.2-25 50 Hz

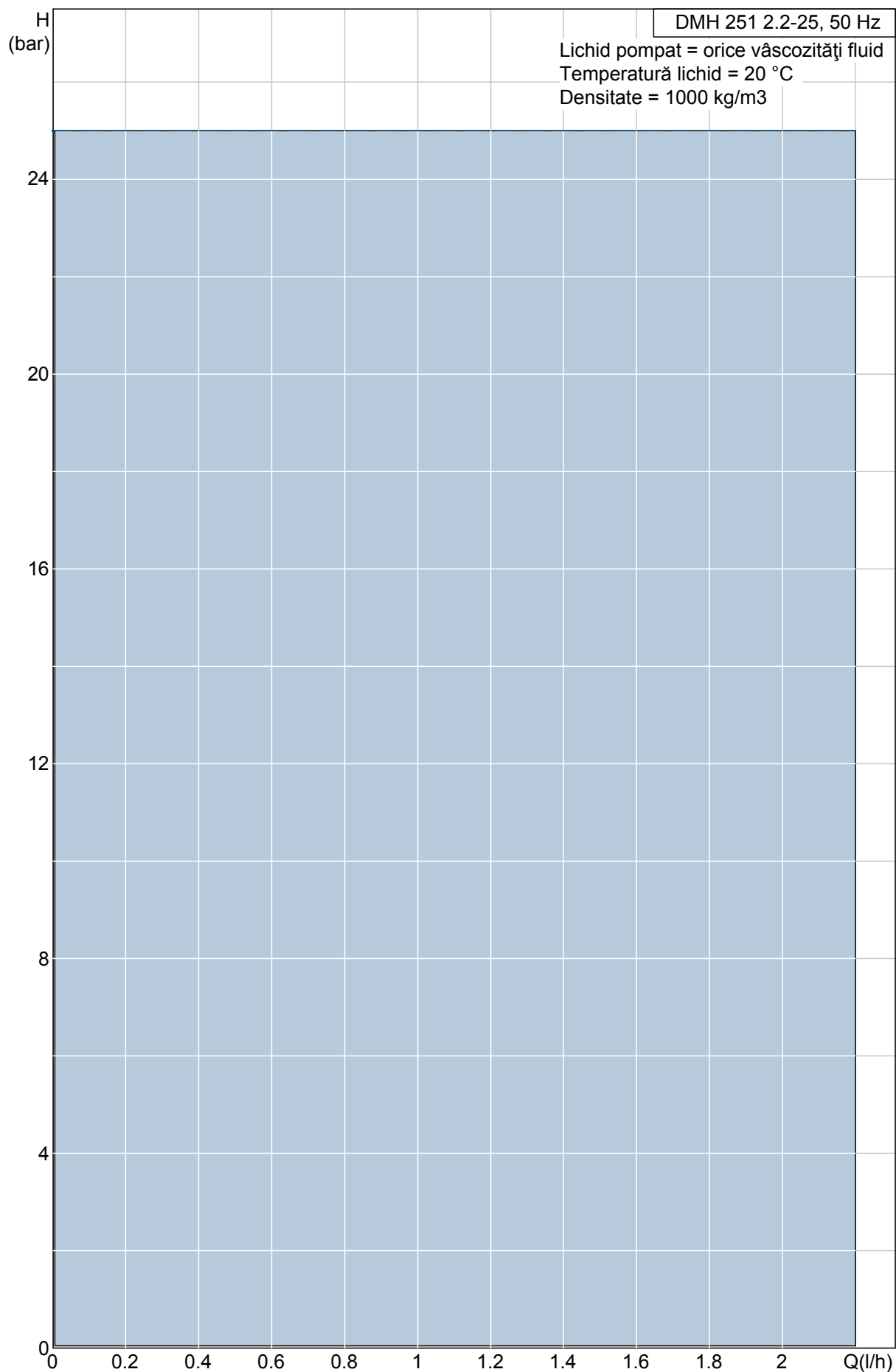

Descriere	Valori și tipuri
Nume produs:	DMH 251 2.2-25
Nr. produs:	96721683
Numărul EAN:	5700837850278
Technical:	
Capacitate maximă:	2.2 l/h
Aprobări pe etichetă:	CE
Clapet de sens încorporat:	Standard
Materials:	
Corpul pompei (stator):	Oțel inoxidabil, DIN 1.4401
Supapă cu bilă:	Oțel inoxidabil, DIN 1.4401
Garnitură:	FKM
Instalație:	
Presiune de funcționare maximă	25 bar
Aspirație pompă:	Threaded, Rp 1/4
Refulare pompă:	Threaded, Rp 1/4
Liquid:	
Lichide pompate:	orice vâscozități fluid
Temp. lichid:	20 °C
Densitate:	998.2 kg/m ³
Electrical data:	
Puterea de întarare - P1:	0.09 W
Frecvența rețelei electrice:	50 Hz
Tensiune nominală:	1 x 120 V 50/60 Hz
Grad de protecție (IEC 34-5):	IP 65/F
Protecție Ex standard	NO
Lungimea cablului:	2 m
Tip de conectare cablu:	USA and Canada, 120 V
Controls:	
Variante de control:	AR
Control turație:	Manual stroke length adjustment knob
Panou de comandă:	Lateral (către butonul de reglare)
Control nivel:	Input for dual-level sensor or external start/stop
Control impuls:	Input for pulse control, multiplier/divisor func.
Alte intrări/ieșiri:	Input for 0/4-20 mA control
Others:	
Motor servo:	NO
Detectie scurgeri:	NO
Grundfos Alldos PN:	251-2.2-10013

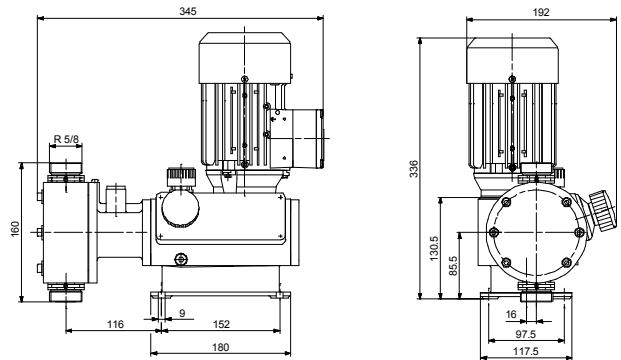
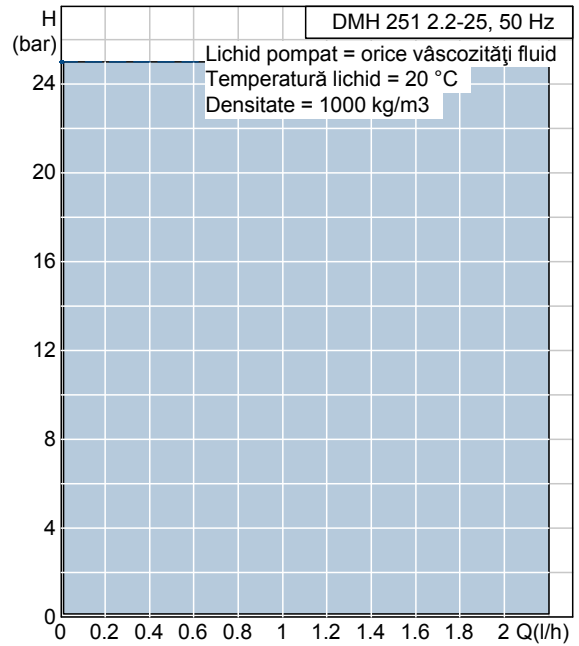

96721683 DMH 251 2.2-25 50 Hz

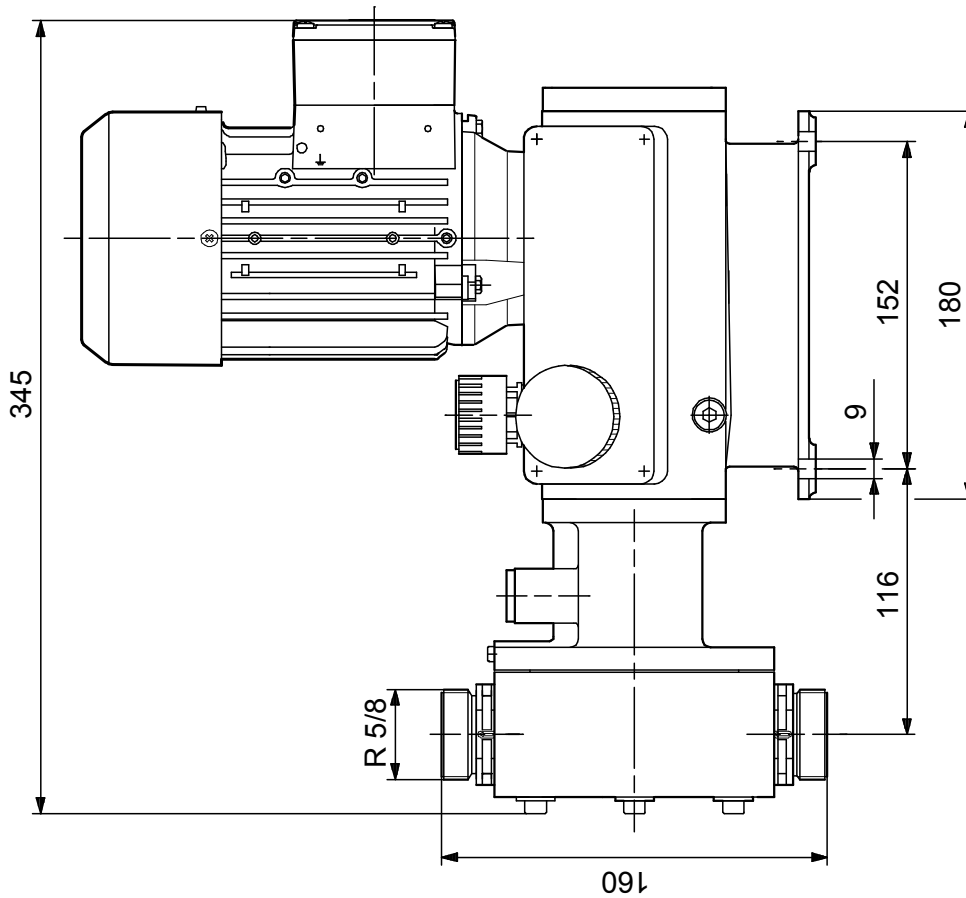
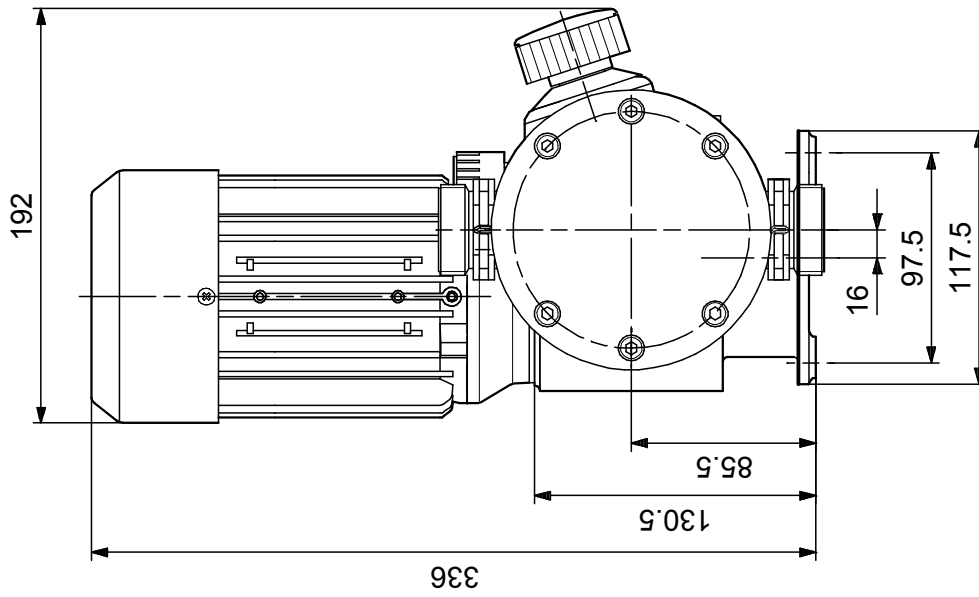

Note! All units are in [mm] unless others are stated.
Disclaimer: This simplified dimensional drawing does not show all details.